

DOUBLE ENDED SHEAR BEAM LOAD CELL

SPECIAL FEATURES :

- High Accuracy.
- Good Reliability.
- Ultra - Precision.
- Excellent Linearity.
- Economy.
- Easily Installed.
- High Repeatability.
- Robust Body.



SPECIFICATIONS

Capacity	:	10, 20, 30 Tonne.
Model	:	DESB - 14, 24, 34.
Rated Output	:	2.0 ± 0.01 mV/V.
Input Resistance	:	$700 \Omega \pm 10 \Omega$.
Output Resistance	:	$700 \Omega \pm 10 \Omega$.
Non-linearity	:	0.02 % FS.
Hysteresis	:	0.02 % FS.
Combined Error	:	0.03 % FS.
Zero Balance	:	1.5 % FS.
Non-repeatability	:	0.02 % FS.
Creep	:	0.02 % FS/30 min.
Temperature effect on span	:	0.05 % FS/10° C.
Temperature effect on zero	:	0.02 % FS/10° C.
Temperature, compensated	:	-10 to +40° C.
Temperature, operating	:	-35 to +65° C.
Excitation, recommended	:	10 - 12 VDC.
Safe Overload	:	150 % FS.
Ultimate Overload	:	300 % FS.
Insulation Resistance	:	5000 M Ω .
Protection Class	:	IP 68.
Cable Length	:	13 mtrs.

LOAD CELL DIMENSIONS : -

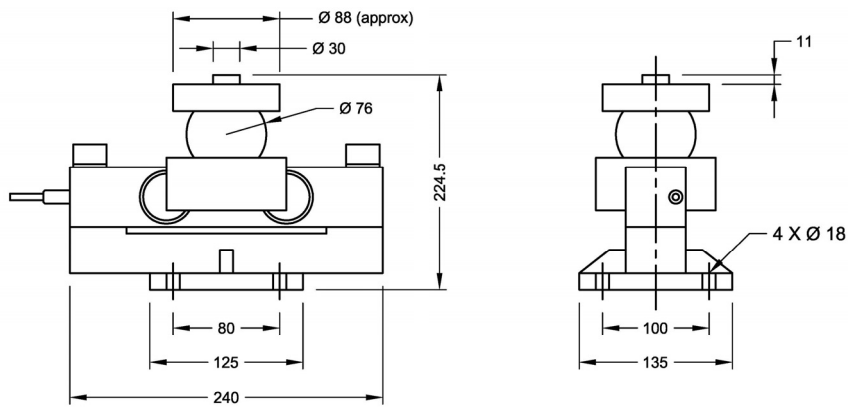

CONNECTION DETAILS : -

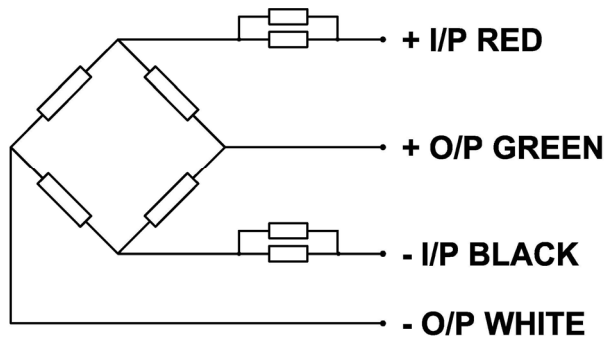

ORDERING INFORMATION : Specify Capacity, Model & Quantity.

CAPACITY	MODEL	QUANTITY

Please Communicate to :

EPOCH

Instruments & Controls Pvt. Ltd.

Office : MIG 132, 2nd Stage, 80 Feet Road, K.H.B. Colony, Basaveshwaranagar, Bangalore - 560 079.

☎ : 080 - 2348 1364, 6576 1259. ☎ : 080 - 2328 3728. E-mail : epochic@vsnl.net

Factory: C - 60, NGEF Industrial Estate, Mahadevapura (PO), Bangalore - 560 048. ☎ : 080 - 2847 6347.

Branch : 403, Kemp Plaza, B-Wing, Opp. Mind Space, Chincholi Bunder, Malad (West), Mumbai - 400 064.

☎ : 022 - 4003 0704, 4003 0705, 4003 0706. ☎ : 022 - 4003 0707. E-mail : synopsis@vsnl.com